

THE PALM CLUB WEST VILLAGE II
PART OF LAKESIDE GREEN
(P.B. 50, PAGES 106-107)

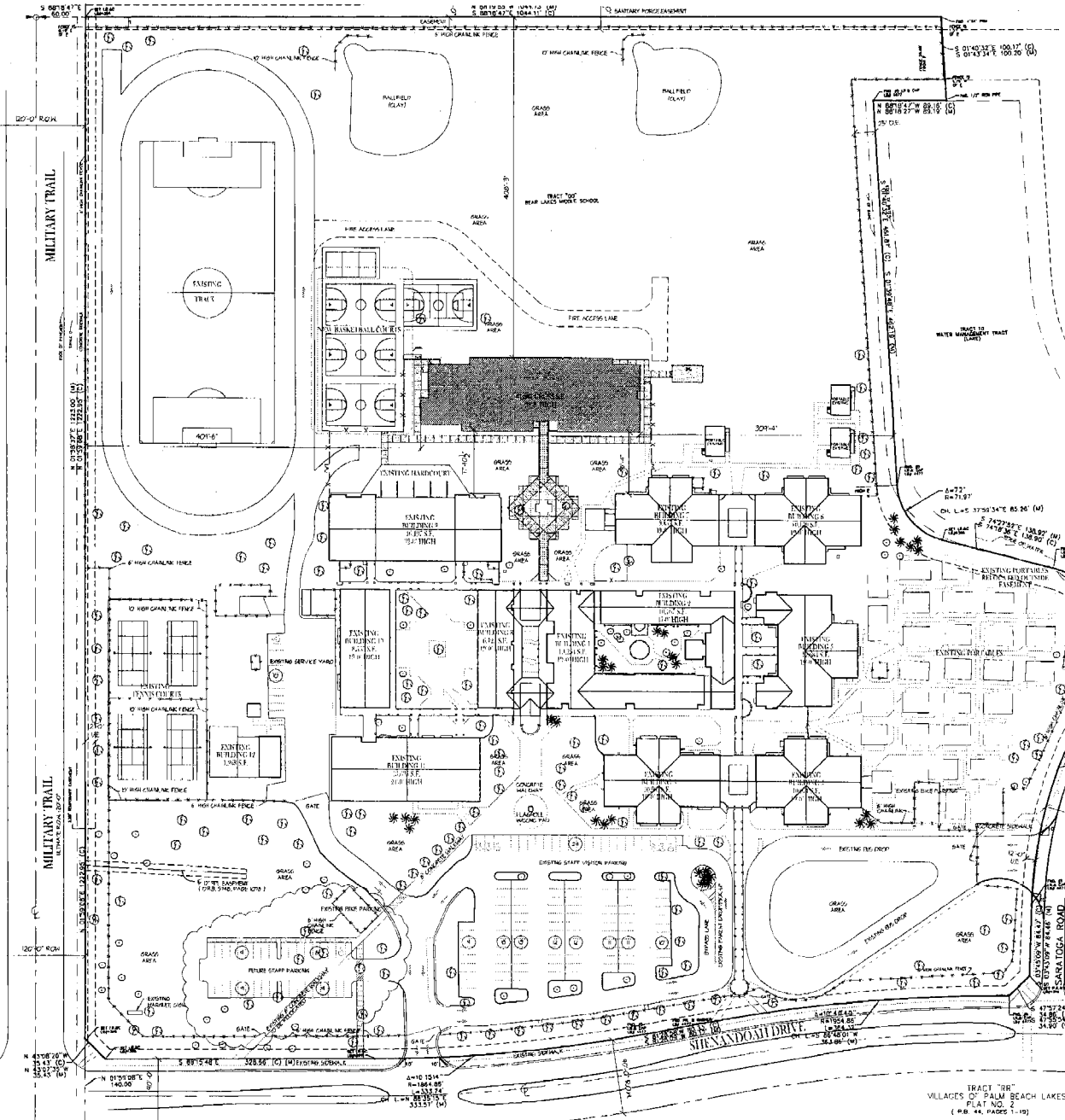

TABULAR DATA		
PETITION NUMBER	NONE FOUND	
NAME OF PROJECT	BEAR LAKES MIDDLE SCHOOL, PUBLIC	
PROPOSED USE	PUBLIC SCHOOL	
FUTURE LAND USE DESIGNATION	COMMUNITY SERVICE	
ZONING DISTRICT		
SECTION/PHASE/RANGE	12 / 43 / 42	
PRECEDENT CONTROL NO.	14-42-43-12-03-002-0170	
TOTAL GROSS ACRES/± SF	30.43 / 1,325,500	
STUDENT STATIONS	1,000	
TOTAL PARKING SF	123,62 SF	
TOTAL PROPOSED CLASSROOM ADDITION SF	2,304 SF (4,504 S.F. GROSS)	
FLOOR AREA RATIO (FAR)	20%	
BUILDING COVERAGE	84%	
BUILDING HEIGHT (MAX)	37'-6"	
NO. OF STOREY FLOORS	2 (PROPOSED BUILDING)	
FINISHED GRADE ELEVATION	FF 19.00 EXISTING & PROPOSED	
PARKING TABULATION		
	REQUIRED PER GRF	PROPOSED
STAFF / FACILITY	176	100
VISITOR	12	15
EXTRACURRICULAR (STUDENTS)	8	4
IC PARKING (STUDENTS)	1	1
TOTAL	64	131

STANFORD AT THE VILLAGES
OF PALM BEACH LAKES
(P.B. 82, PAGES 141-145)

SITE LOCATION MAP

SITE PLAN

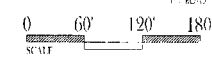

STANFORD AT THE VILLAGES
OF PALM BEACH LAKES
(P.B. 82, PAGES 141-145)

TRACT "DB"
VILLAGES OF PALM BEACH LAKES
PLAT NO. 2
(P.B. 44, PAGES 7-10)

APPROVAL STAMP

tercila
cowymanche
architects

AA PROJECT
3043 commercial plaza, south
west palm beach, florida 33411 tel: 561.834.1147 fax: 561.458.1102

Class Size Reduction
Bear Lakes Middle School
SDPBC Project No. 1941-8050
The School District of Palm Beach County
West Palm Beach, Florida

commission 24035
date 03/01/05
revision
no.
drawing
DRC
copyright 2005